

**vb tools**

# K5R-100 5-Axis Vice



- ▶ 256 mm clamping range
- ▶ with swivel jaw
- ▶ Easy to convert

# K5R-100 5-Axis Vise

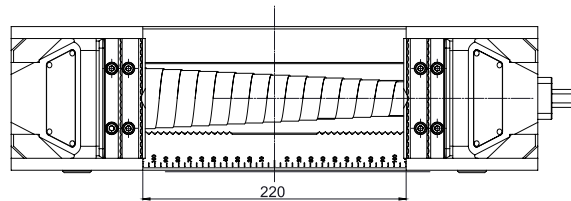
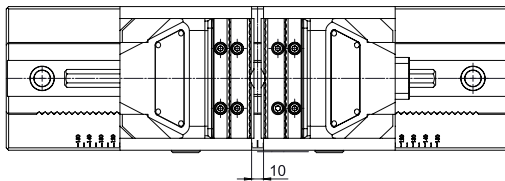
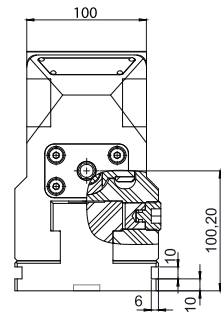
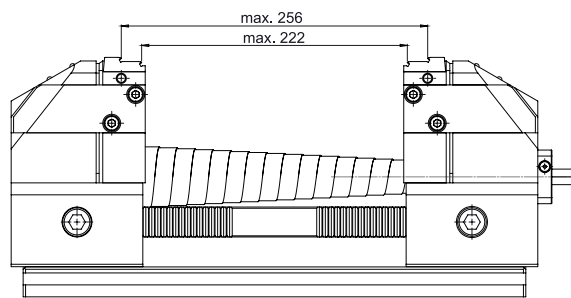
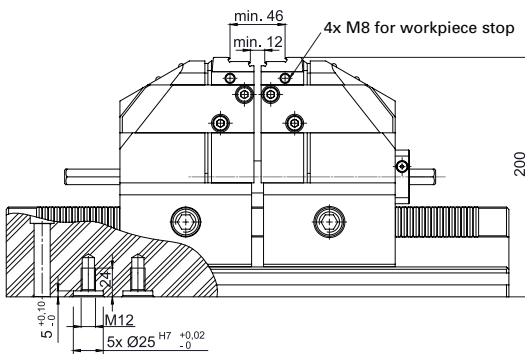
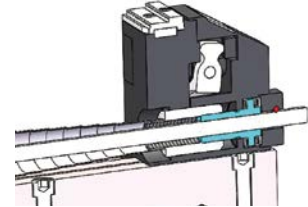
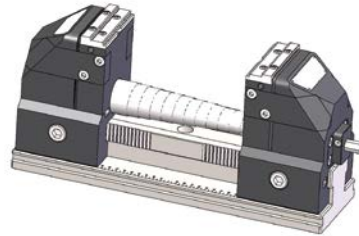
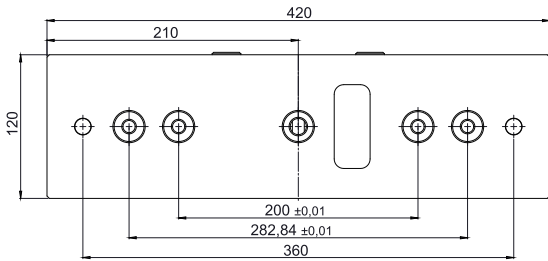

Item No.	Designation
K5R-100	5-Axis Vise

## Workpiece stop

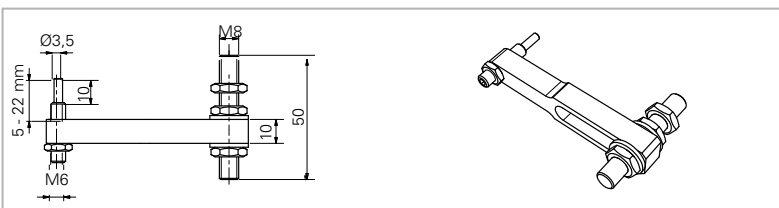

## Torque wrench



Item No.	Designation
748-76-M8	Workpiece stop
748-NM	Torque wrench 20-100 Nm with lever reversible ratchet , drive 1/2"
748-SW13	1/2" hexagon socket wrench 13 mm

## Clamping force chart

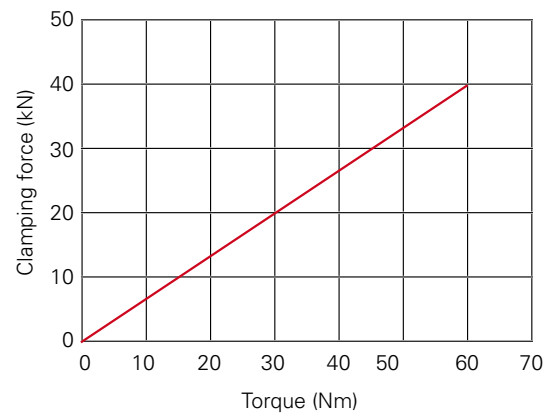

# K5R-100 5-Axis Vise

## Accessories

Pos.	Designation	piece unit	Item No.
1	T-Handle Socket wrench	1	ZSS 100 260 150 047
2	Torque wrench	1	ZSS 100 260 150 046
3	Short Socket 13mm	1	ZSS 100 260 150 050
4	Long Socket 13mm	1	ZSS 100 260 150 051
5	Hex Bit Socket 12mm	1	ZSS 100 260 150 052
6	Hex Bit Socket 4mm	1	ZSS 100 260 150 053
7	Clamping claw	4	ZSS 100 260 150 056
	Workpiece stop	1	ZSS 100 260 150 060
	Alignment bolts	2	ZSS 100 260 150 048 D25 DA...
	Clamping bolt + nuts	3	ZSS 100 260 150 062 B ..
	Drive shaft short	1	ZSS 100 260 150 033

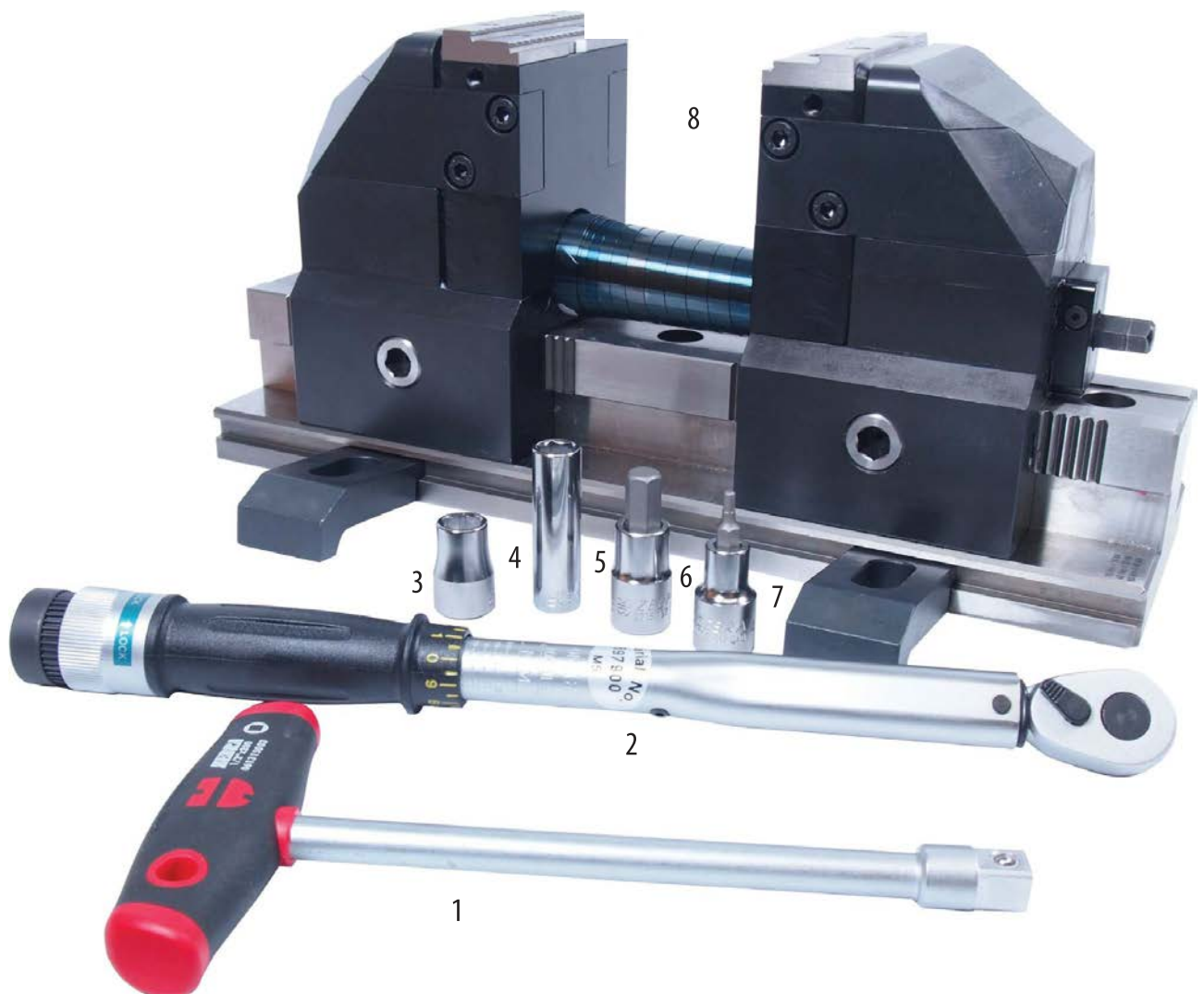

## K5R-100 5-Axis Vise

### Jaws



Designation	piece unit		Item No.
Grip jaw 3,5 mm	2		ZSB 100 260 150 015
Smooth jaw hardened, 3,5 mm	2		ZSB 100 260 150 019
Grip jaw 10 mm	2		ZSB 100 260 150 020
Smooth jaw hardened, 10 mm	2		ZSB 100 260 150 021
Soft jaws steel	2		ZSB 100 260 150 022
Soft jaws aluminium	2		ZSB 100 260 150 023
Swivel jaw Grip 3,5 mm	2		ZSB 100 260 150 044
Grip jaw with carbide insert	2		ZSB 100 260 150 042
Carbide insert+screw	16		ZSB 100 260 150 043