



# Upgrade your lathe to coolant through without losing machining range

## SMART & EASY

Existing driven tools can be easily converted to through coolant

## SLIM & SHORT

Improved design providing the minimized interference contour

## reCool® ERAX

The patented solution to retrofit driven tools to internal coolant tools – New and improved

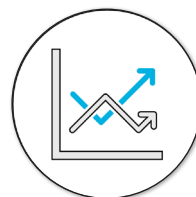

Increase productivity

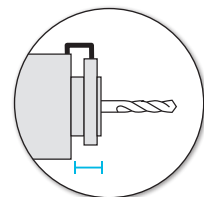

Designed for internal threaded live tools

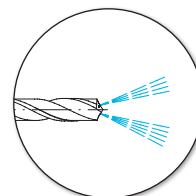

Upgrade to Internal coolant easily

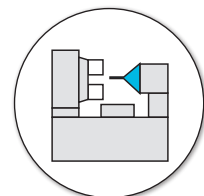

Optimized for lathe machines

**Get your free reCool® ERAX test now!**

Learn more at [try.rego-fix.ch/recool/retrofit](http://try.rego-fix.ch/recool/retrofit)

## Retrofit driven tools and turning machines to internal cooling with reCool®

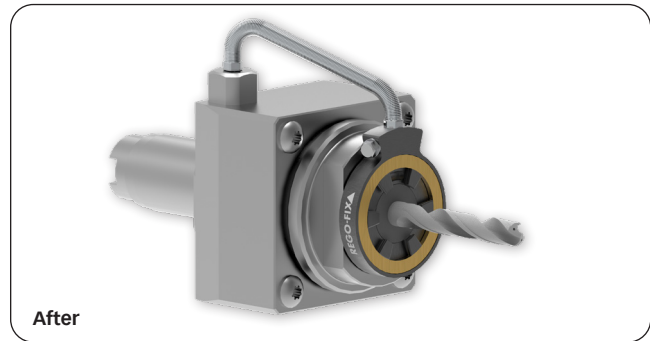
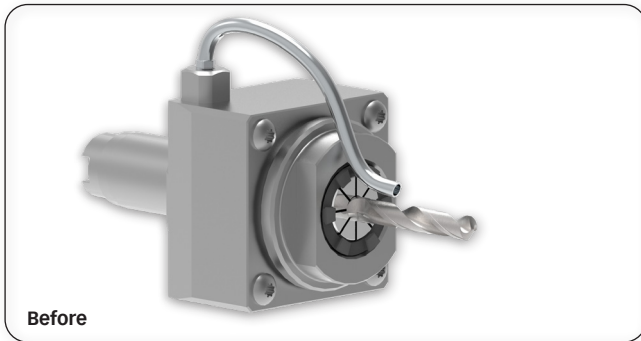

- // For driven tools with inner thread
- // Short design: optimising machining range
- // Maximum pressure 100 bar
- // Maximum RPM 12,000 min<sup>-1</sup>
- // Copper-like coating for best friction
- // Tools shank diameter 3-20 mm
- // Suited for emulsion and oil
- // For ER collets to ISO 15488 / DIN 6499
- // To be used with KS/DS disks

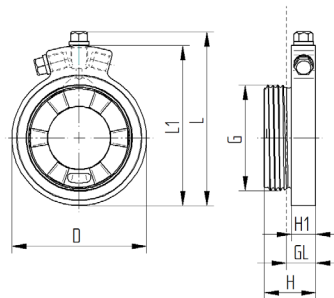

Type	Part no.	d [mm]	L [mm]	L1 [mm]	H [mm]	H1 [mm]	GL [mm]	G
<b>Coolant supply system with outer thread, rotational</b>								
RCR/ERAX 16	3716.29000	34.0	46.0	41.5	14.5	7.6	9.0	M24 x 1.0
RCR/ERAX 20	3720.29000	37.5	49.5	45.0	15.5	7.6	9.0	M28 x 1.5
RCR/ERAX 25	3725.29000	41.0	53.0	48.5	15.8	7.6	9.0	M32 x 1.5
RCR/ERAX 32	3732.29000	49.0	61.0	56.5	16.9	7.6	9.0	M40 x 1.5



RCR/ERAX

Type	Part no.	Length	Included
<b>Steelflex hose for RCR/ERAX</b>			
SET RHS-AX L080	3799.99080	80 mm	Hollow bolt SET HS6100RF6
SET RHS-AX L100	3799.99100	100 mm	Hollow bolt SET HS6100RF6
SET RHS-AX L120	3799.99120	120 mm	Hollow bolt SET HS6100RF6



Steelflex hose

Type	Part no.	Description
<b>Hollow bolt for RCR/ERAX</b>		
SET HS8100RF8	3799.90808	Hollow bolt M8 x 1.00 mm and ringfitting Ø 8.00 mm
SET HS8125RF8	3799.90818	Hollow bolt M8 x 1.25 mm and ringfitting Ø 8.00 mm
SET HS6100RF6	3799.90606	Hollow bolt M6 x 1.00 mm and ringfitting Ø 6.00 mm



Hollow bolt set

Type	Size	Type	Size
<b>Accessories</b>		<b>Torque wrench TORCO-FIX</b>	
KS/ER	3–20 mm	TORCO-FIX	0–II
DS/ER	3–20 mm		
ER collets	ER 16–32		
A-E AX wrench head	ER 16–32		
V-E extension	ER 16–32		
E AX wrench	ER 16–32		

### REGO-FIX AG

Obermattweg 60 / 4456 Tenniken / Switzerland  
[www.rego-fix.com](http://www.rego-fix.com)

Your REGO-FIX Partner